

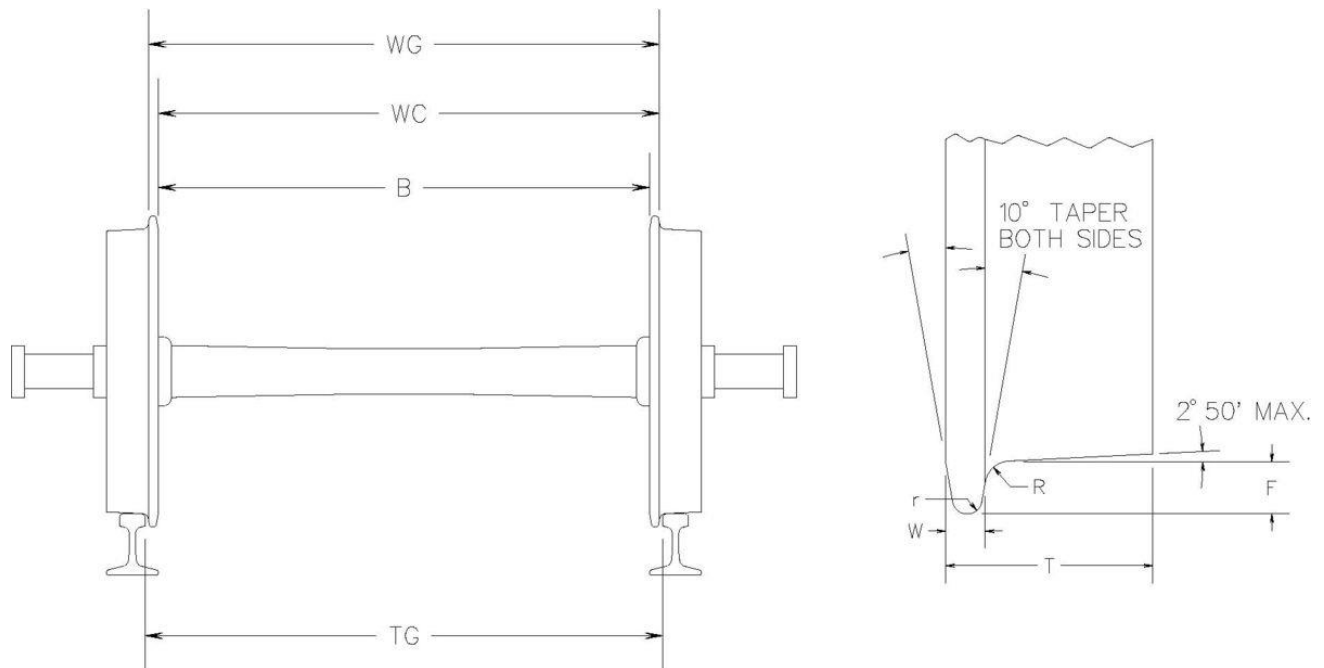

MARICOPA LIVE STEAMERS

Wheel Standard and Axle Loads

5-21-16



Drawing courtesy of Bill Donovan of RealTrains.com
http://ibls.org/mediawiki/index.php?title=File:IBLS_Wheel_Standard_1981.jpg

Notes:

1. Each line which joins an arc is tangent to the arc
2. In prototype practice, the flange radius (r) is not a simple radius.

TG	7.500 min
T	0.750 min
W	0.156 max
F	0.210 max
R	0.094 +0.020 / -0.015
B	7.120 +0.020 / -0.010

NOTE:

The dimensions noted above are NOT for new construction, rather they are for evaluating equipment that has been in service and subject to wear.

Maximum Axle Load is 425 lbs